

## How to use of the gear-shift of Super CVT i installation car.

2.0L car(Z grade)

### Working of gear-shift

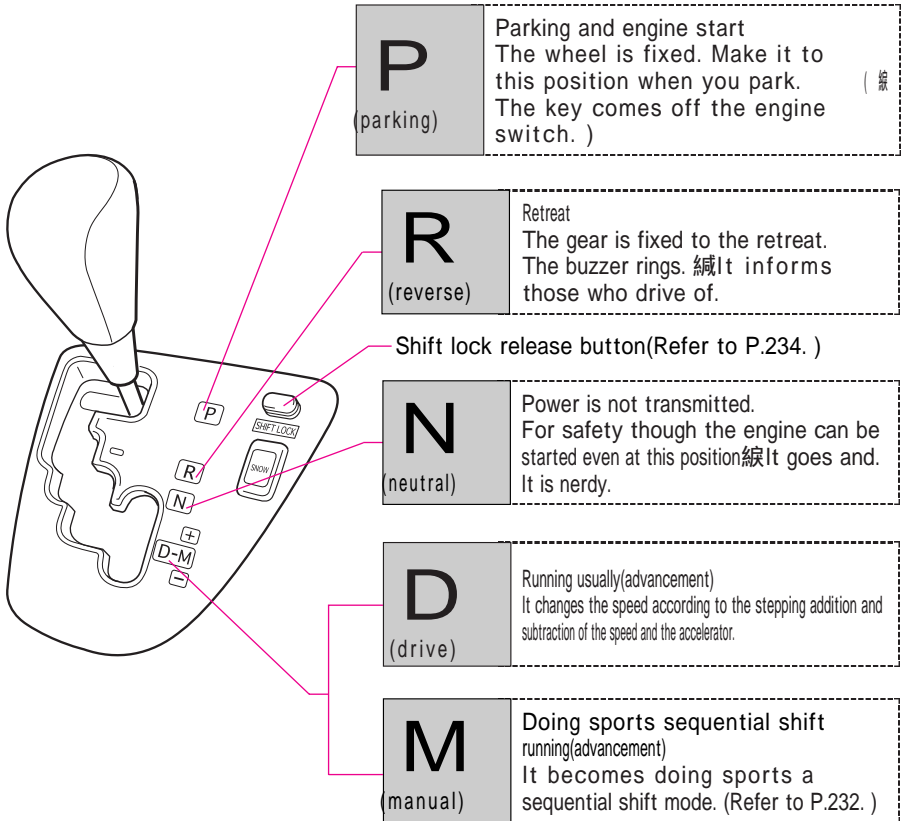



## ● Handling of gear-shift

### - Operation of gear-shift

縦と 綺 The operation of ..drinking.. Ida is F as for the brake pedal.  
Go after completely stopping the car of seeing.

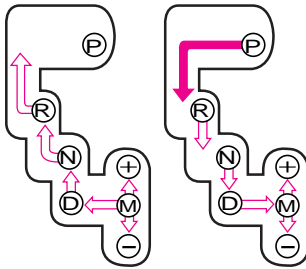

With stepping on the brake pedal, Change  
Move the lever along the gate.



The gear-shift along the gate そのま  
ま Move it.

そのま

ま Move it.

ま Move it.

ま Move it.

ま Move it.

ま Move it.

ま Move it.

ま Move it.

ま Move it.

ま Move it.

ま Move it.

ま Move it.

ま Move it.

ま Move it.

ま Move it.

ま Move it.

ま Move it.

ま Move it.

ま Move it.

ま Move it.

ま Move it.

ま Move it.

ま Move it.

ま Move it.

ま Move it.

ま Move it.

ま Move it.

ま Move it.

ま Move it.

ま Move it.

ま Move it.

ま Move it.

ま Move it.

ま Move it.

## ● How to use of doing sports the sequential shift mode.

- How to doing sports sequential shift mode to switch

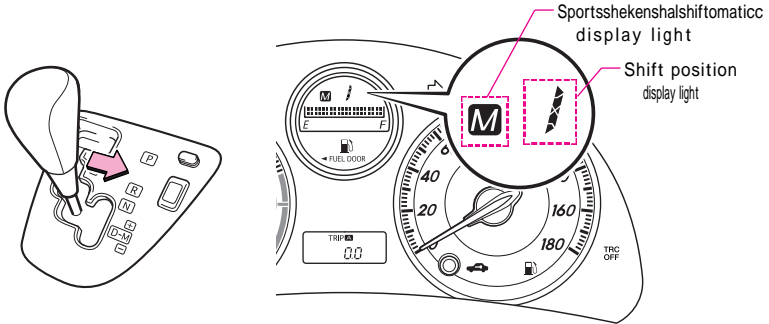

The gear-shift 綯It becomes and doing sports a sequential shift mode. The changing the speed steps can be switched by + side or operating the gear-shift on the side. -

The Sports sequential shift mode display light lights when changing to doing sports the sequential shift mode. (Refer to P.259.) -

The gear-shift 綺And doing sports the sequential shift mode are made clear, and it returns to a usual control.

- Method of shift change

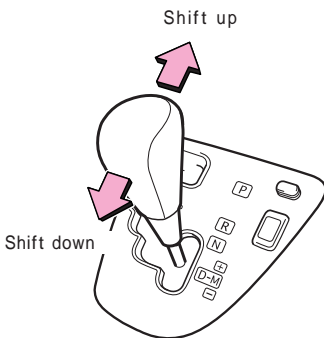

Move the gear-shift to + side when you do the shift improvement.







Move the gear-shift to the side when you do the down of the shift. -

It changes the speed by one step whenever the gear-shift is operated.

1  $\begin{matrix} \oplus \\ \ominus \end{matrix}$  2  $\begin{matrix} \oplus \\ \ominus \end{matrix}$  3  $\begin{matrix} \oplus \\ \ominus \end{matrix}$  4  $\begin{matrix} \oplus \\ \ominus \end{matrix}$  5  $\begin{matrix} \oplus \\ \ominus \end{matrix}$  6  $\begin{matrix} \oplus \\ \ominus \end{matrix}$  7

- The changing the speed steps that have been selected between 1-7 are displayed in the shift position display light. (Refer to P.256.)

- Working of each changing the speed steps

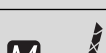
	
	
	
	
	
	
	The changing the speed steps are fixed to M1.



Knowledge

About the changing the speed steps of doing sports the sequential shift mode

- The down of the shift is automatically done to M1 when stopping after it runs excluding M1. When running after it stops, it becomes a start from M1. -
- When stopping, it is fixed to M1.

Contents



Warning

Basic  
series operation

Driving  
Handling  
device

The  
Handling indoor  
equipment

good. Safety  
of  
To  
theory, practice  
and  
equipment

How  
to  
attention  
associate driving  
car

Maintenance

Myriad  
One(D)

with

Index

### About the warning buzzer

There is a limitation in the shift operation to secure the driving performance for safety, and it is likely not to be shifted to hoped the changing the speed steps. The warning buzzer rings when the down of the shift by the shift operation is not done.

It is abnormally lucky of the system.

The gear-shift 絢Neither nor the Sportsshekenshalshiftomaticc display light light.  
As for Nipponia nippon, abnormality of the system is thought. Receive the check at once in the Toyota shop.  
In this case, the gear-shift 綺It becomes the same control as.

### About the safety feature

#### Shift lock system

The system that prevents the gear-shift of the automatic car being mis-operated. -

The gear-shift if you did not step on the brake pedal 緘It twines and Re bar cannot be operated.

蘆When the engine switch is ACC or LOCK, it is not possible to operate it even if stepping on the brake pedal.

蘆It is not likely to be able to operate it when stepping on the brake pedal with the gear-shift knocked down to the passenger's seat side. Operate it previously depressing the brake pedal.

- 緘The key doesn't come off in things except the engine switch.

蘆When you pull out the key from the engine switch緘Give to me. ( 緘The key is AC.  
It is not possible to spend from C in LOCK. )

- 緘And the buzzer ring.

蘆The buzzer rings. 緘It informs those who drive of.

蘆The person outside the car must not hear of the sound. (No warning sound to the person outside the car. )

How to use of the shift lock release button.

The gear-shift : by any chance. 緘Use it when it twines and you cannot operate it. -

Make the engine switch ACC with stepping on the brake pedal, and operate the lever while pushing the shift lock release button. -

The breakdown in the shift lock system etc. is thought, and receive the check at once in the Toyota shop.

## ● How to use of the SNOW switch.

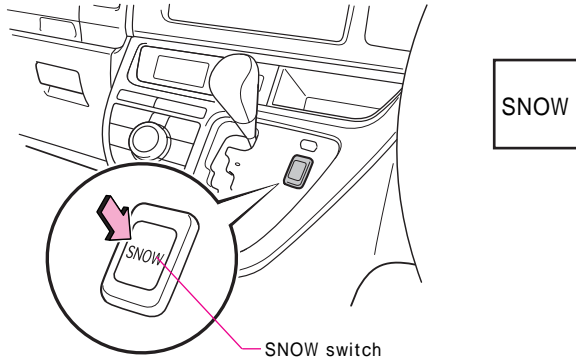

It changes into the snow mode if the SNOW switch is pushed, and it is released when pushing again. -

The SNOW display light in the meter lights when changing to the snow mode. (Refer to P.258. )

### Knowledge

#### About the snow mode

The engine power is controlled, and it is suitable for the start on a slippery road such as the snow roads.

#### About the operation condition

- When the engine switch is turned on, it is possible to use it. -
- When the engine switch is made ACC or LOCK, the snow mode is made clear.



## Working of gear-shift

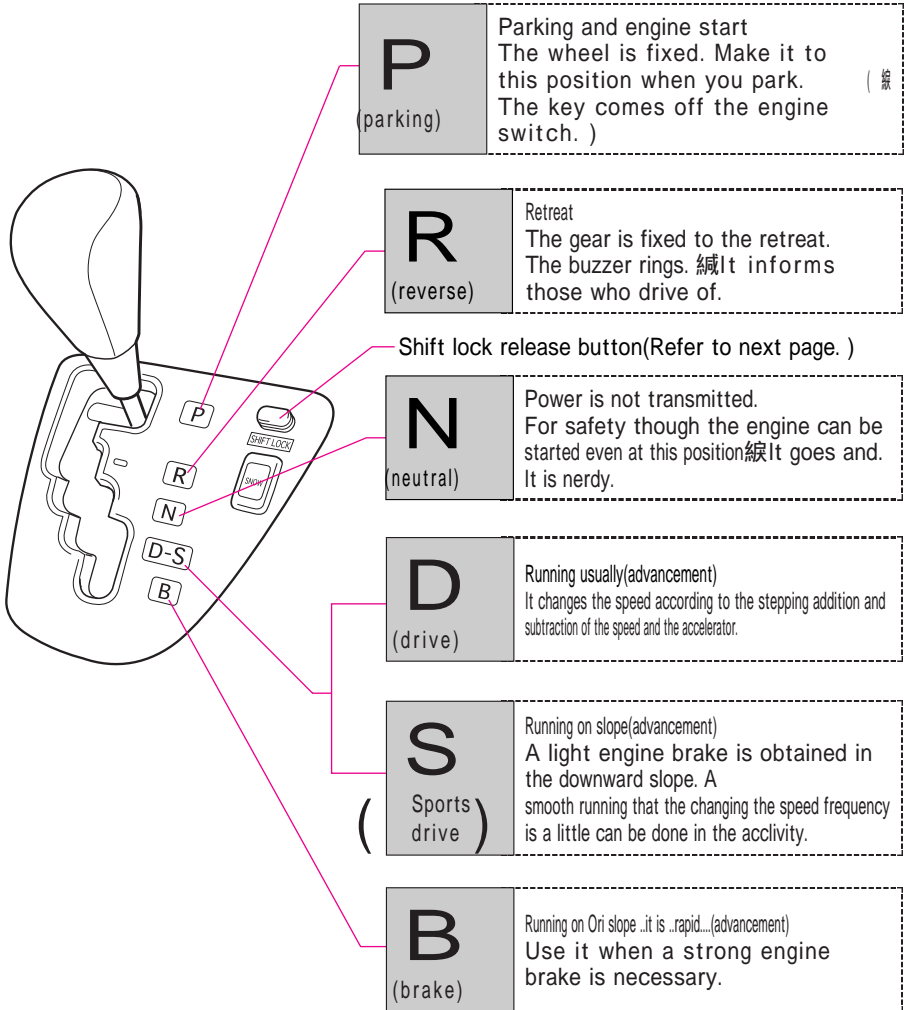

## ● Handling of gear-shift

### - Operation of gear-shift

緘と 綺 The operation of ..drinking.. Ida is F as for the brake pedal.  
Go after completely stopping the car of seeing.

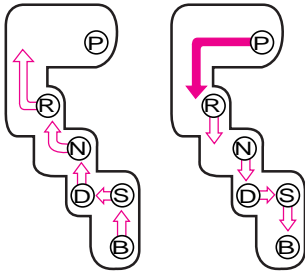

With stepping on the brake pedal, Change  
Move the lever along the gate.



The gear-shift along the gate そのま  
ま Move it.



### Knowledge

#### About the safety feature

#### Shift lock system

The system that prevents the gear-shift of the automatic car being mis-operated. -

The gear-shift if you did not step on the brake pedal 緘It twines and Re bar cannot be operated.

葦When the engine switch is ACC or LOCK, it is not possible to operate it even if stepping on the brake pedal.

葦It is not likely to be able to operate it when stepping on the brake pedal with the gear-shift knocked down to the passenger's seat side. Operate it previously depressing the brake pedal.

- 緘The key doesn't come off in things except the engine switch.

葦When you pull out the key from the engine switch 緘Give to me. ( 緘The key is AC.  
It is not possible to spend from C in LOCK. )

- 緘And the buzzer ring.

葦The buzzer rings. 緘It informs those who drive of.

葦The person outside the car must not hear of the sound. (No warning sound to the person outside the car. )

How to use of the shift lock release button.

The gear-shift : by any chance. 緘Use it when it twines and you cannot operate it. -

Make the engine switch ACC with stepping on the brake pedal, and operate the lever while pushing the shift lock release button. -

The breakdown in the shift lock system etc. is thought, and receive the check at once in the Toyota shop.



---

## ● How to use of the SNOW switch.

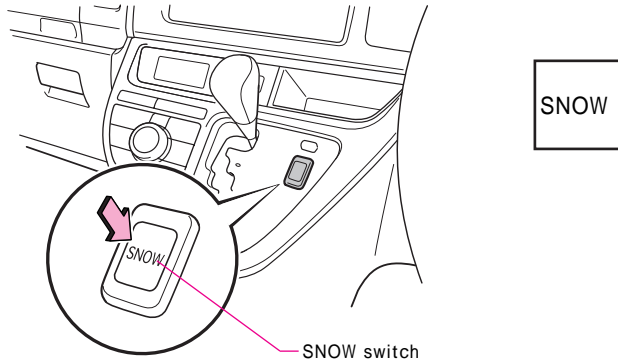

It changes into the snow mode if the SNOW switch is pushed, and it is released when pushing again. -

The SNOW display light in the meter lights when changing to the snow mode.  
(Refer to P.258. )

### Knowledge

#### About the snow mode

The engine power is controlled, and it is suitable for the start on a slippery road such as the snow roads.

#### About the operation condition

- When the engine switch is turned on, it is possible to use it. -
- When the engine switch is made ACC or LOCK, the snow mode is made clear.

# ***MEMO***

---

Contents



Warning

Basic  
controls, operation

Driving  
Handling  
device

The  
Handling indoor  
equipment

Good Safety  
of  
To  
theory/vehicle  
and  
equipment

How  
to  
attention  
driving  
car

Maintenance

Myriad  
One/D  
C  
M

Index